

Bez.: Montageanleitung 12

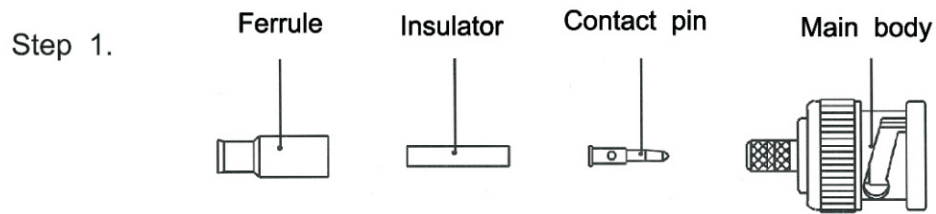

Step 1. All parts of the connector are shown. A crimp tool is necessary to complete the connection.

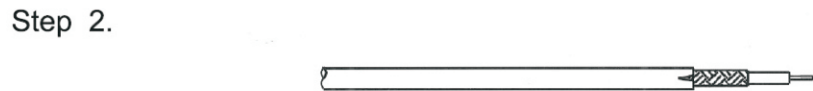

Step 2. Strip the inner conductor, dielectric, and jacket.

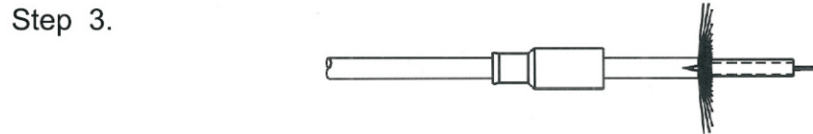

Step 3. Slide the **Ferrule** onto cable, then fold back braid wire and slide the **Insulator** onto dielectric as shown.

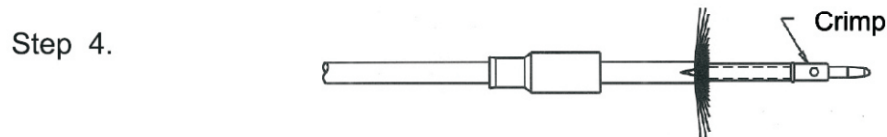

Step 4. Insert inner conductor into the **Contact pin**, crimp it with crimp tool as shown.

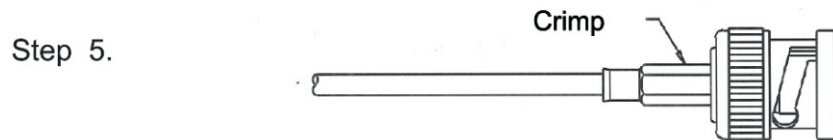

Step 5. Push cable and parts into the **Main body** until it stops. Then slide the **Ferrule** over braid wire and against the **Main body**, crimp it with the crimp tool as shown.

www.bkl-electronic.de

Technische Änderungen vorbehalten. Ausführungen können variieren. Sollten Sie ein Muster benötigen kontaktieren Sie uns bitte.

BKL-ELECTRONIC Kreimendahl GmbH • Märkenstück 14 • 58509 Lüdenscheid
Tel: +49 (0)2351-3621-0 • Fax: +49 (0)2351-3621-29 • info@bkl-electronic.de

